

Fixing Methods

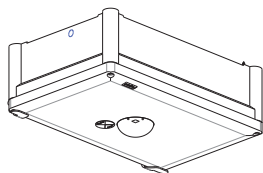

FIX TO CEILING

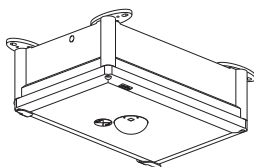

FIX TO CEILING VIA LUGS

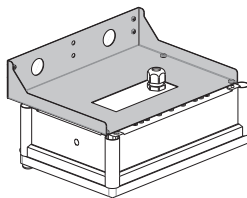

WALL BRACKET

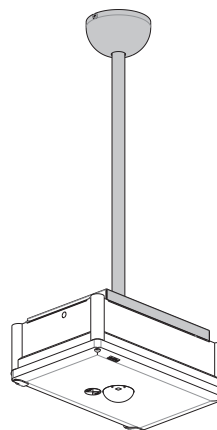

ROD SUSPENSION

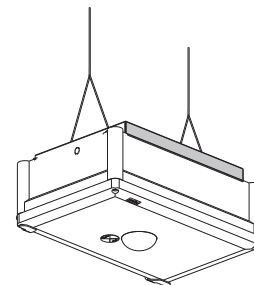

WIRE SUSPENSION

Specifications

All Models	
Supply voltage	230 – 240V a.c.
Colour Temperature	5000K
IP Rating	IP65
Net weight	1.7kg

Installation

Fix to ceiling

1. Drill a 20mm hole on the side of the unit closest to the terminal block.
2. Install the gland in position.

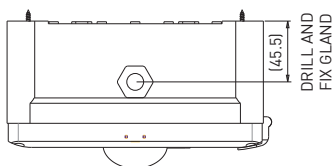

3. Fit the power cable¹ through the gland and terminate into the terminal block.

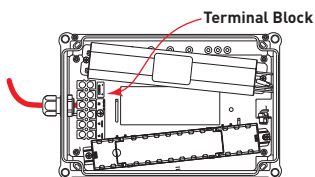

4. Fix the box to the ceiling through the 4 channels. Use 8 to 12 gauge screws (not supplied).

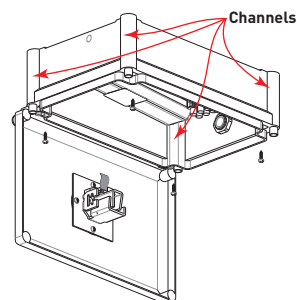

5. Close the Goldstar Maximus cover and lock into position.

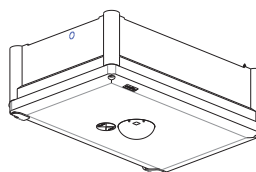

Note 1: Use 10mm circular cable

Fix to ceiling via lugs

1. Install the 4 lugs to the box with the screws provided.

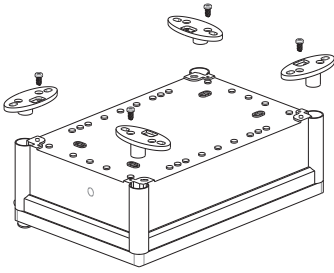

2. Drill a 20mm hole on the side of the unit closest to the terminal block.

3. Install the gland in position.

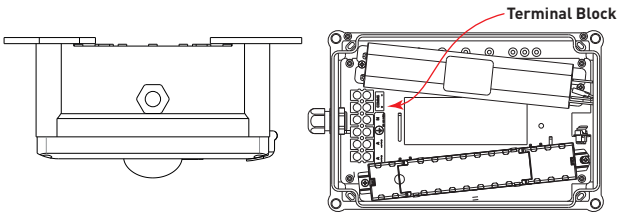

4. Fit the power cable¹ through the gland and terminate into the terminal block. Close the Goldstar Maximus cover and lock into position.

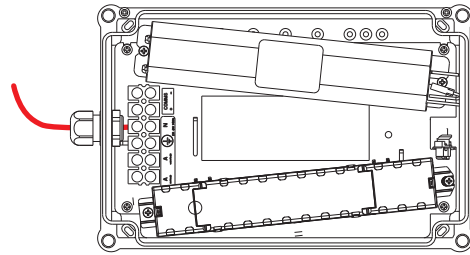

5. Fix the box to the ceiling through the 4 lugs. Use 10 to 14 gauge screws (not supplied).

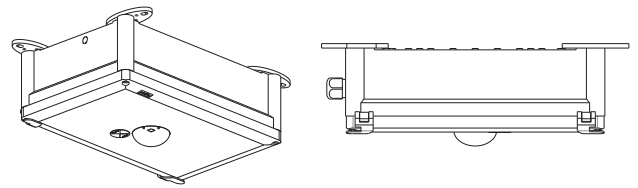

Wall bracket Mount

1. Drill a 20mm hole on the back of the unit in the space provided. Use the wall bracket as a drill template.

2. Install the gland in position.

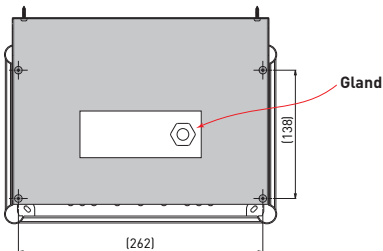

Note: The gland can also be installed on the side of the unit.

3. Fix the bracket to the back of the unit with the 4 screws provided.

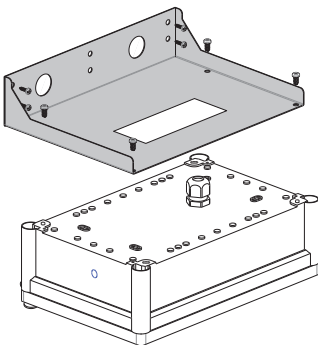

4. Fit the power cable¹ through the gland and terminate into the terminal block.

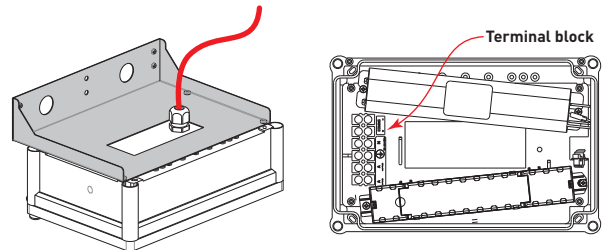

5. Fix the bracket to the wall. Use 8 to 12 gauge screws (not supplied).

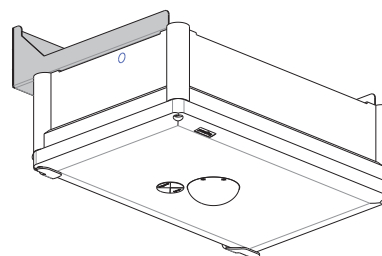
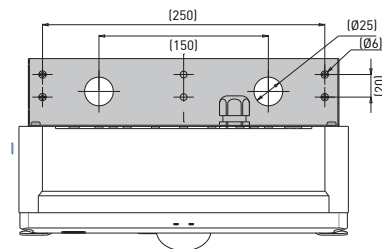

Note 1: Use 10mm circular cable

Rod Suspension Mount

1. Use the plate as a template to drill a 20mm hole in the back of the unit.
2. Install the gland in position.

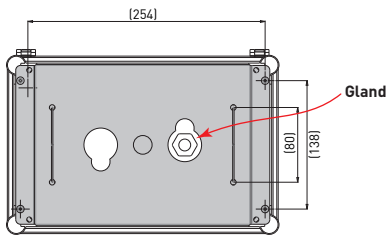

3. Connect the rod to the plate and fix with the nuts.

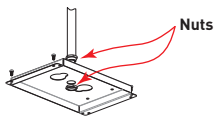

4. Fit the power cable¹ through the rod & the gland and terminate into the terminal block.

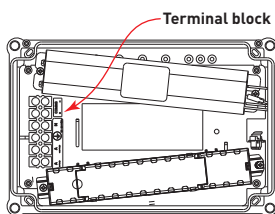

5. Fix the plate to the unit with the 4 screws provided.

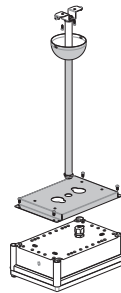

6. Fix the rod to the ceiling (for installing on rigid ceilings).

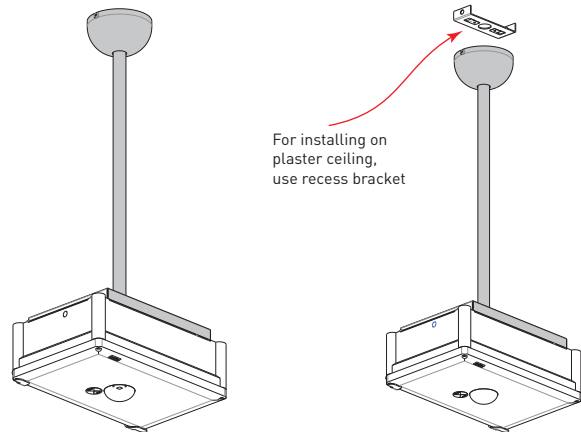

Wire Suspension Mount

1. Use the plate as template to drill a 20mm hole in the back of the unit.
2. Install the gland in position.

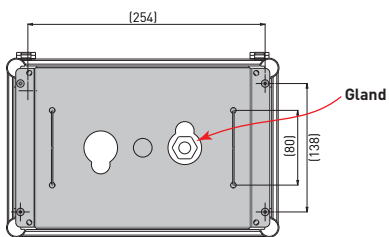

3. Install the suspension wires in the plate through 4 small holes on each corner.
4. Fix the plate to the unit with the screws provided.

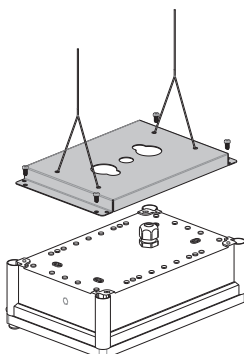

5. Fit the power cable through the gland and terminate into the terminal block.

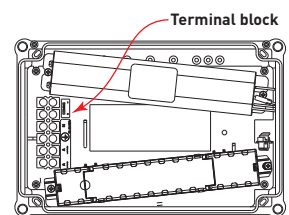
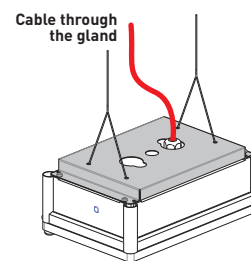

6. Fix the wire onto the ceiling.

